



Jellicoe Gardens

Stanmore

£845,000

A four bedroom, link-detached house available chain free with Davidson Frost-Wellings.

On the ground floor the house has a bay-windowed, eat-in kitchen, a spacious L-shaped reception and dining room with direct access to the private rear garden. There is also a utility room and downstairs WC. On the first floor the house there is a master bedroom with built-in wardrobes and an ensuite bathroom. There are two further double bedrooms, a fourth single bedroom, plus a family bathroom.

The house is available with no onward chain, a private driveway for multiple cars as well as a semi-integrated garage. The rear garden is secure, secluded with a patio, lawn and borders.

Harrow Council Tax Band G.

Viewing

Please contact our Davidson Frost-Wellings Office on 020 8954 8806 if you wish to arrange a viewing appointment for this property or require further information.

- Four bedrooms
- Two bathrooms
- Off street parking
- Excellent location
- Chain free
- Freehold



Floor Plan

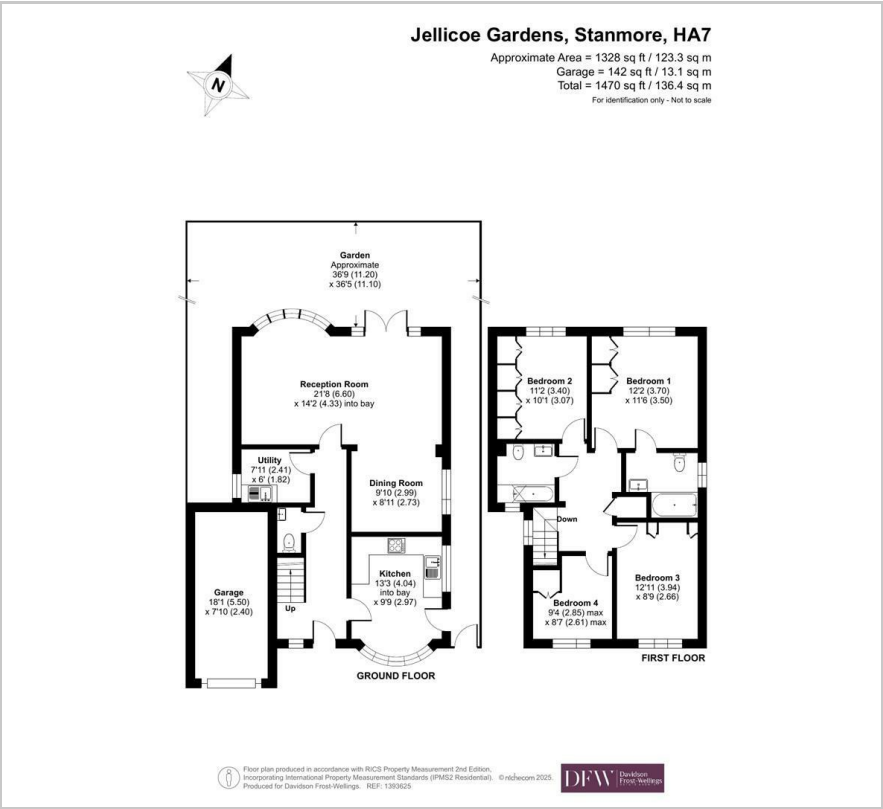

Area Map



Energy Efficiency Rating		
	Current	Potential
Very energy efficient - lower running costs		
(92 plus) A		78
(81-91) B		
(69-80) C		
(55-68) D	64	
(39-54) E		
(21-38) F		
(1-20) G		
Not energy efficient - higher running costs		
England & Wales		EU Directive 2002/91/EC



These particulars, whilst believed to be accurate are set out as a general outline only for guidance and do not constitute any part of an offer or contract. Intending purchasers should not rely on them as statements of representation of fact, but must satisfy themselves by inspection or otherwise as to their accuracy. No person in this firms employment has the authority to make or give any representation or warranty in respect of the property.